

NO	QTY	PART NO	DESCRIPTION	STD SEAL KIT
1	2	21500018	SCREW, CAP, SOCH, M3 X 5, ALY	
2	2	21500200	WASHER	
3	1	39010017	SEAL,CROWN,13/16x1x5/32	X
4	2	39050042	O-RING, (-011)	X
5	1	39051072	O-RING, (-120)	X
6	1	39052036	SEAL, LL, (5/8 X 1/8 X 1/8 X 7/8)	X
7	2	43068006	PLUG, PORT, HOLLOW HEX, G1/4	
8	1	48211012	PISTON, CYL, BB, COMBO, 17,7 KN, 20	
9	1	48211021	GLAND, CYL, BB, COMBO, 17,7 KN	
10	1	39V11020	WIPER,PRESS-IN, (5/8)	X
N/A	N/A	60211201	KIT, SEAL, CYL, BB, COMBO, DA, 17.7 KN	NOTED

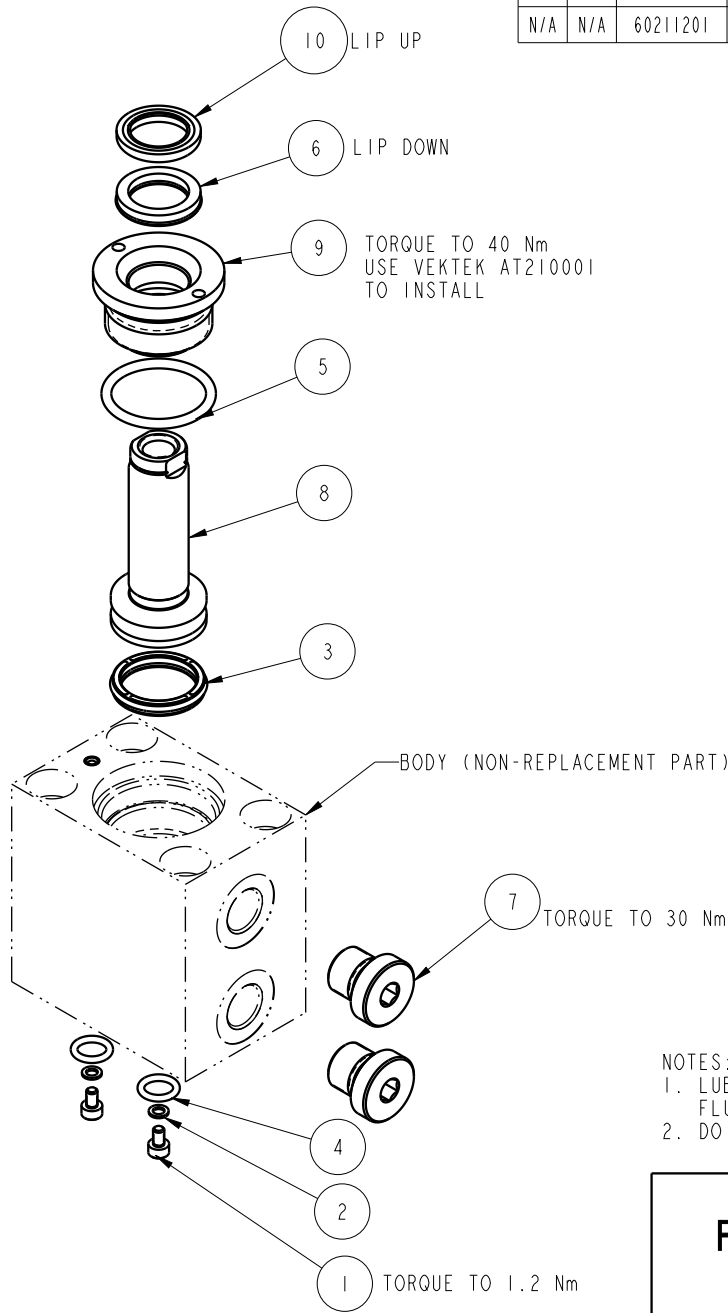

- NOTES:
- LUBRICATE ALL SEALS WITH CLEAN HYDRAULIC FLUID PRIOR TO INSTALLATION.
  - DO NOT USE SILICONE TYPE LUBRICANTS.

### PARTS LIST



VEKTEK, INC.  
1334 E. SIXTH AVE. P.O. BOX 625  
EMPORIA, KS. 66801 U.S.A.

ASSEMBLIES AFFECTED

PARTS LIST,CYL,BB,COMBO,DA,17.7 KN,20

42112102

L2112102

SIZE  
A

MPLV4202

REV  
D

D	4246	RELEASE	MJUST	8/4/20
REV	IN ACCORDANCE WITH ECN	EFFECTIVE DATE	REVISED BY	DATE
DRW BY:	K. ROEMER	<b>DRAWING STATUS: Released</b>		
DATE:	11/09/11	PRODUCTION APPROVED FOR RELEASED STATUS ONLY		

FORM FEG035\_PL\_ASIZE, REV. B

SHEET 1 OF 1